

Project	
Nomenclature	
Type	Date
Approval	
Notes	

The BLRD is a recessed lay-in fixture designed for use in T-bar ceilings and is well suited for use in office spaces where a clean, professional appearance is required.

Luminaire Summary

Features

- Operating temperature ranges available from -20C to 25C
- Standard 0 - 10V dimming
- Available in 2700K, 3000K, 3500K, 4000K, 5000K and 6500K

Approvals

- ETL certified to UL Canada and United States standards
- Made with UL Listed components

Mounting

- Holes provided for chain or hanger, and wire mounting support for T-Bar ceilings

Construction

- Manufactured in Ontario, Canada
- Shallow fixture design for easy installation
- Powder-coated in low-gloss white
- Access panel provided for easy wiring
- Cold-rolled steel parts are precision bent for added strength and rigidity

Electrical

- Available in 120-277V, 120-347V and 347V

Options

- Wireless Controls Available
- 90 and 95+ CRI Options Available
- 120-347V(UN3) Available
- Passive/Active Air Handling Available

Ordering Information

Fill in the fields below with your product selections. If you need help with this section, [contact your local sales professional](#).

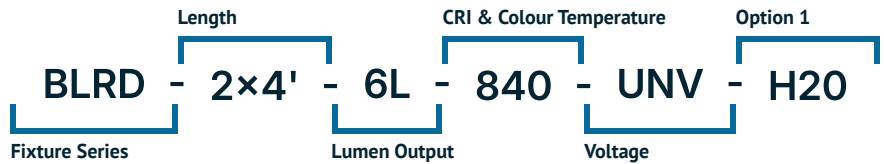

1	2	3	4	5
BLRD				

Series	Length & Lumen Output				CRI	Colour Temp	Voltage
BLRD	1x4 / 2x2	2L (2000lm)	2x4	5L (5000lm)	8 - 80 CRI	27 - 2700K	UNV - 120-
	1x4 / 2x2	2.5L (2500lm)	2x4	5.5L (5500lm)	9 - 90 CRI	30 - 3000K	277V
	1x4 / 2x2	3L (3000lm)	2x4	6L (6000lm)	1 - 95+ CRI	35 - 3500K	UN3 - 120-
	1x4 / 2x2	3.5L (3500lm)	2x4	6.5L (6500lm)		40 - 4000K	347V
	1x4 / 2x2	4L (4000lm)	2x4	7L (7000lm)		50 - 5000K	347 - 347V
	1x4 / 2x2	4.5L (4500lm)	2x4	7.5L (7500lm)		65 - 6500K	
	1x4 / 2x2	5L (5000lm)	2x4	8L (8000lm)			
	2x4	3L (3000lm)	2x4	8.5L (8500lm)			
	2x4	3.5L (3500lm)	2x4	9L (9000lm)			
	2x4	4L (4000lm)	2x4	9.5L (9500lm)			
	2x4	4.5L (4500lm)	2x4	10L (10000lm)			

Options

Lenses

BLANK | Frosted Acrylic

Dimming

- B11 | 0-10V Dimming Leads
- B12 | Line Voltage Dimming
- B27 | Dim-to-off Driver
- B** | Other Options Available*

Controls

- WC10* | Encelium Wireless Controls
- WC18* | NX Wireless Controls
- WC19* | Avi-on Wireless Controls
- WC22* | JDRF Wireless Controls

Motion Sensors

- WX15 | Internal Dimming Low Voltage Microwave Sensor
- WC20 | Leviton Low-Voltage Sensor
- W** | Other Options Available*

Emergency Driver

- B17 | UL924 10W Battery Back-up
- F8 | UL924 Emergency Relay

Air Handling

- H20 | Housing with Passive Air Handling
- H24 | Housing with Active Air Handling

Finish

- BLANK | Standard Low Reflectance White
- C5 | Matte Black
- CUSTOM* | Custom Colour Choice

Packaging

- BLANK | Individually Boxed on Pallets
- P0 | Bulk Packaging
- P** | Other Options Available*

Mounting

- M15 | Surface Mount Kit (packaged separately)

T-Bar & Drywall Kits

- BLANK | Standard T-Bar
- TB39 | 9/16"
- H40 | Drywall Kit (packaged separately)

Warranty

- CL7 | 10-Year Comprehensive Warranty Upgrade

Documentation and Resources

All files and resources are available on our website for download. Files and resources are also embedded as links in this document, listed below. Additional files may be available upon request. Please contact your local sales agent [here](#) or contact sales@bjtake.com for more information.





 [BLRD-1x4-5L-840-L18](#)

 [BLRD-1x4-7L-840-L18](#)

 [BLRD-2x4-6L-840-L18](#)

Certifications and Listings

Certifications that apply to this fixture and its possible configurations are listed here. More information available upon request.

Icon	Description
	Wireless Controls Available
	ETL Listed
	90 and 95+ CRI Options Available
	120-347V(UN3) Available

Usage Applications

This fixture can be used in a variety of applications, and is ideal for the following:

Usage Application
Hospitals
Offices
Schools

Warranty Statement

BJ Take products are tested and/or inspected prior to being packaged for shipment and are guaranteed from the day the product is shipped for a period of ten-year LED chip warranty and a five-year comprehensive component warranty. This can be upgraded to a ten-year comprehensive warranty on request.

BLRD

Recessed LED Troffer | Dimensions

BLRD, 1x4 Foot, Top Dims

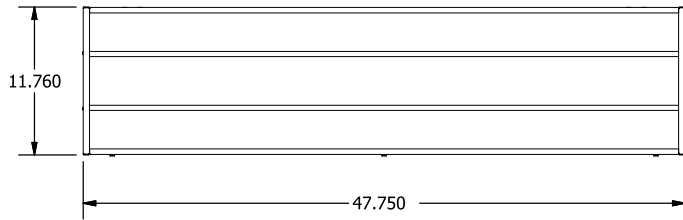

1x4 End View

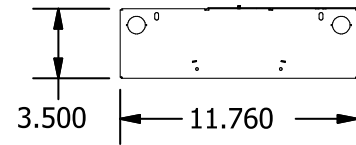

BLRD, 2x4 Foot, Top Dims

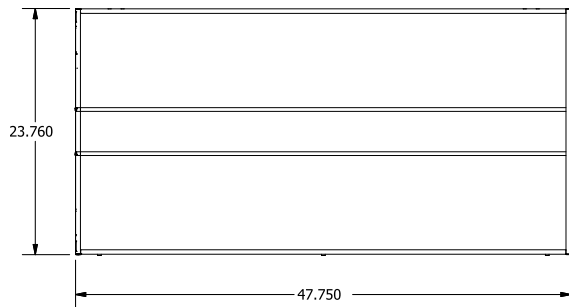

2x4 End View

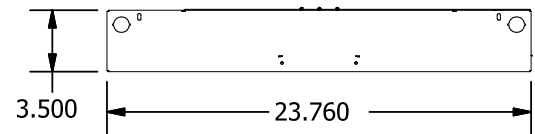

BLRD, 2x2 Foot, Top Dims

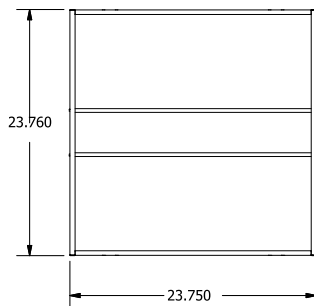

2x2 End View

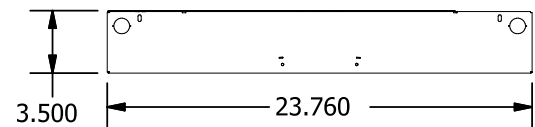

- * Drawings aren't to scale
- * Standard tolerances apply
- * Specifications may change without notice

Important Information

Below you will find the available wattage charts for the BLRD. For any required specifications that are not listed here, please contact our sales team at sales@bjtake.com to request any additional information.

BLRD, 1x4 Foot Wattage

Size	Lumen Output	Fixture Wattage
14	2.00	14.80
14	2.50	18.40
14	3.00	22.10
14	3.50	25.80
14	4.00	29.50
14	4.50	33.20
14	5.00	36.80

BLRD, 2x2 Foot Wattage

22	2	14.8
22	2.50	18.40
22	3.00	22.10
22	3.50	25.80
22	4.00	29.50
22	4.50	33.20
22	5.00	36.80

BLRD, 2x4 Foot Wattage

24	3	21.7
24	3.50	25.30
24	4.00	29.00
24	4.50	32.70
24	5.00	36.30
24	6.00	43.70
24	7.00	51.00
24	8.00	58.40
24	9.00	65.70
24	10.00	73.00

BLRD, Light Loss Factor

CCT	Output%
2700K	92.95%
3000K	95.51%
3500K	96.80%
4000K	100%
5000K	101.28%
90CRI	84.72%

BLRD-2x4-6L-840-L18

Cone of Light

Mtg Height	Light Level	Beam Diameter
6.0 ft	83.4 fc	11.1 ft
8.0 ft	46.9 fc	14.8 ft
10.0 ft	30.0 fc	18.5 ft
12.0 ft	20.8 fc	22.1 ft
14.0 ft	15.3 fc	25.8 ft
16.0 ft	11.7 fc	29.5 ft

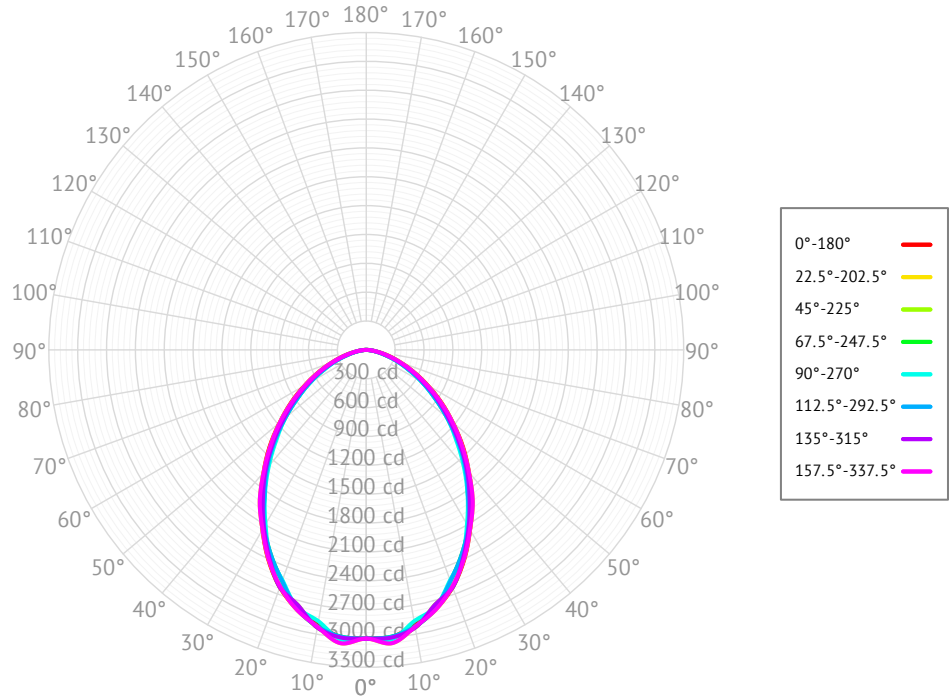

Based on 'BLRD-2x4-6L-840-L18', ie. (BLRD, 2x4 foot, 6000lm, 80 CRI, 4000K, w/ L18 Frosted Acrylic Lens)

Emergency Battery Plan - 10W

Emergency Lighting	Solution System Components	System Operation
Option Code 'B17' - UL 924 listed components that are factory installed in the luminaire	UL 924 listed 10-watt battery integral to the luminaire	Loss of normal power is detected by the B17 emergency light solution and the power supply is switched automatically to the 10-watt integral battery pack which powers the emergency LED lighting driver.
	UL 924 listed LED emergency lighting driver integral to the luminaire	The battery pack and emergency LED driver are UL 924 certified to provide a minimum of 90-minutes of emergency lighting.
	Wiring options for both switched and unswitched emergency lighting	

Emergency Lighting Wiring

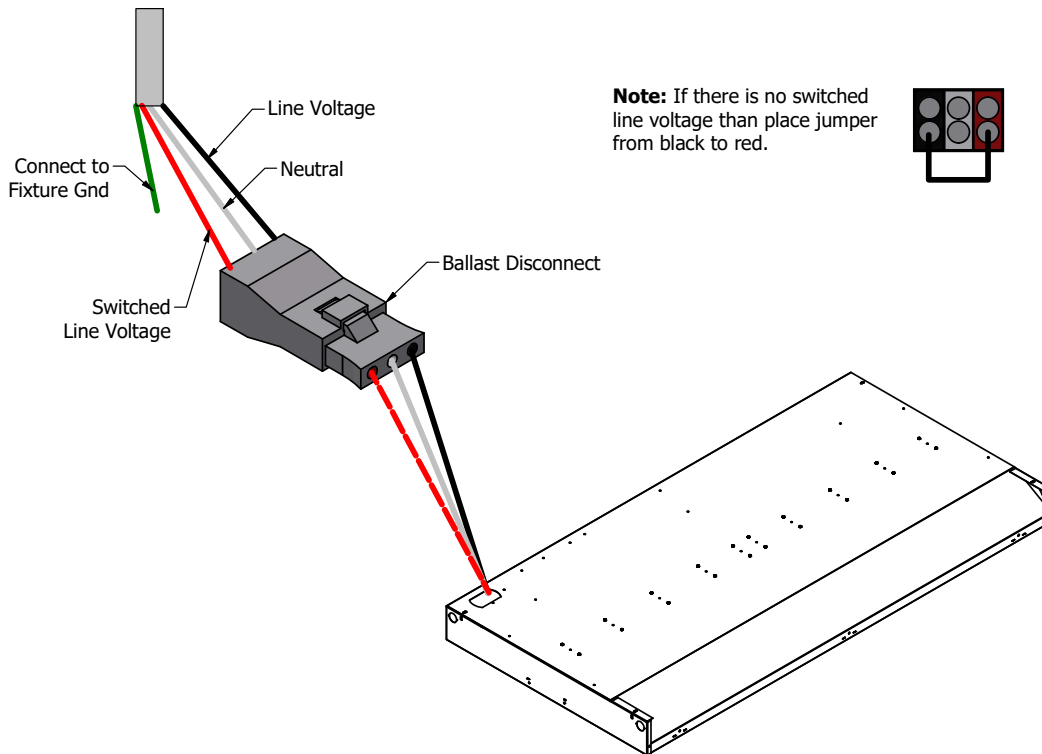

Important Information

More information on emergency lighting options and configurations available on request.