

Project

Product Code

Type

Date

Approval

This superior-grade true length LED decorative retail fixture is ideal for indoor use, where energy efficiency, performance and ease of maintenance is essential. Its rugged design and superior light paths make it an ideal fixture for low and high bay applications

Overview

- L70 of ##,000 hours+
- L90 of ##,000 hours+
- 0 - 10V dimming standard

Construction

- Manufactured in Ontario, Canada
- Precision bent cold-rolled steel components
- Steel end caps for added rigidity
- Powder coated for a clean look and durable finish
- Access panel provided for easy wiring
- Shallow fixture design provides a clean appearance for many environments

Electrical

- ETL certified to UL Canada and United States standards.
- Available in 120-277V, 347V and 480V

Optics

- High-efficiency diffuser maximizes light distribution while providing diffusion of LED point sources and reducing glare

Mounting

- Holes provided for v-hangers, s-hook chain-mounting or aircraft cable.
- Optional pendant mounting and surface mounting is available

Options

- 80 CRI standard - 90 CRI, 95+CRI available
- Motion sensor options available
- Lumen packages are available from 1,750L to 23,000L
- Wire guard
- Available in 3000K, 3500K, 4000K, 5000K, and 6500K
- Bluetooth and wireless mesh networks controls
- Modular Wiring

NOTES

↓ ↓ ↓ NOMENCLATURE

Fixture Type	Fixture Size	Lumen Output	CRI	Color Temp	Driver Voltage	Options
BLLBT						
	2'	1.75 2.25 2.75	8 - 80 CRI 9 - 90 CRI	30 - 3000 K 35 - 3500 K 40 - 4000 K	UNV - 120-277V 347 - 347V 480 - 480V	
	4'	4.5 5.5 6.5 7.5 8.5 9.5 10.5 11.5		50 - 5000 K 65 - 6500 K		
	8'	9 11 13 15 17 19 21 23				

Motion Sensor

- W26 - Photocell Motion Sensor
- W53xxx - On/Off Motion Sensor
- W57 - Dimming Motion Sensor (Dims to 50% and stays at 50% output when unoccupied)
- W** - Other Options Available

Controls

- B11 - 0-10V Dimming Leads
- B17 - Battery Back Up
- B** - Other Options Available
- WC** - Wireless Controls

Colours

- Blank - White Low-Gloss, Matte Finish
- C5 - Black Low-Gloss, Matte Finish
- C** - Other Options Available

Row Mounting

- M54 - Row Mount Body
- W27-XYZ- Daisy-Chain with Wago Wire Connectors
- W22-XY - Molex Row Mounting Wiring

Packaging

- P0 - Bulk Packaging
- P** - Other Options Available

** - Consult BJ Take for more fixture options
 xx - Specify Length
 1 - Custom cord lengths are available
 2 - Consult BJ Take for 3' and 6' lumen outputs

Lenses

- L0 - No Lens
- L55 - Clear Acrylic Lens
- L67 - Optix Lens

Cords

- W3xx - 16/3 White Cord
- W4xx - 16/3 Black Cord
- W** - Other Options Available

XX	Cord Length
06	6 Ft
10	10 Ft
15	15 Ft
20	20 Ft

Example: W306 - 6 foot white cord

Mounting

- M1 - V-Hangers
- M2xx - V-Hangers & Aircraft Cables
- M3xx - Y-Toggle Aircraft Cables
- M24 - Single Pendant Mount
- M25 - Surface Mount Brackets
- M** - Other Options Available

XX	Aircraft Length
05	5 Ft
10	10 Ft
15	15 Ft
20	20 Ft

Example: M310 - 10 foot aircraft cables

Wire Guard

- G1 - White Wire Guard

W27-XY Chart	
X Style	X Style
S - Side	3 - 3 Pole
E - End	4 - 4 Pole
T - Top	5 - 5 Pole
	6 - 6 Pole

W22-XY Chart	
X Style	X Style
E - End	3 - 3 Pole
	4 - 4 Pole
	5 - 5 Pole
	6 - 6 Pole

BLLBT

Suspended Decorative Retail Fixture



DIMENSIONS

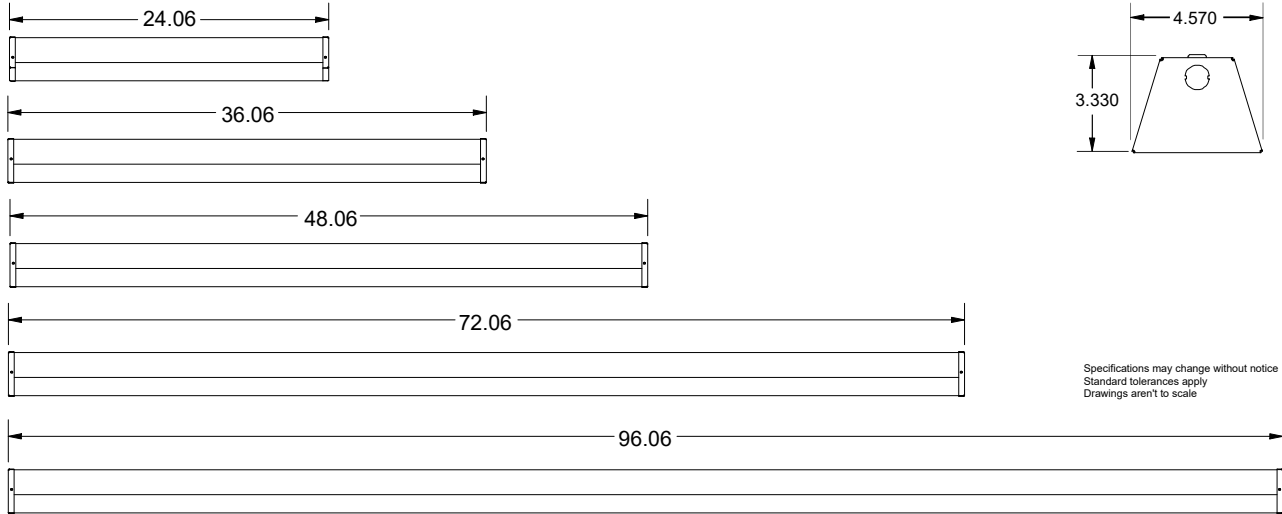

SPECIFICATIONS

ROW MOUNT WIRING

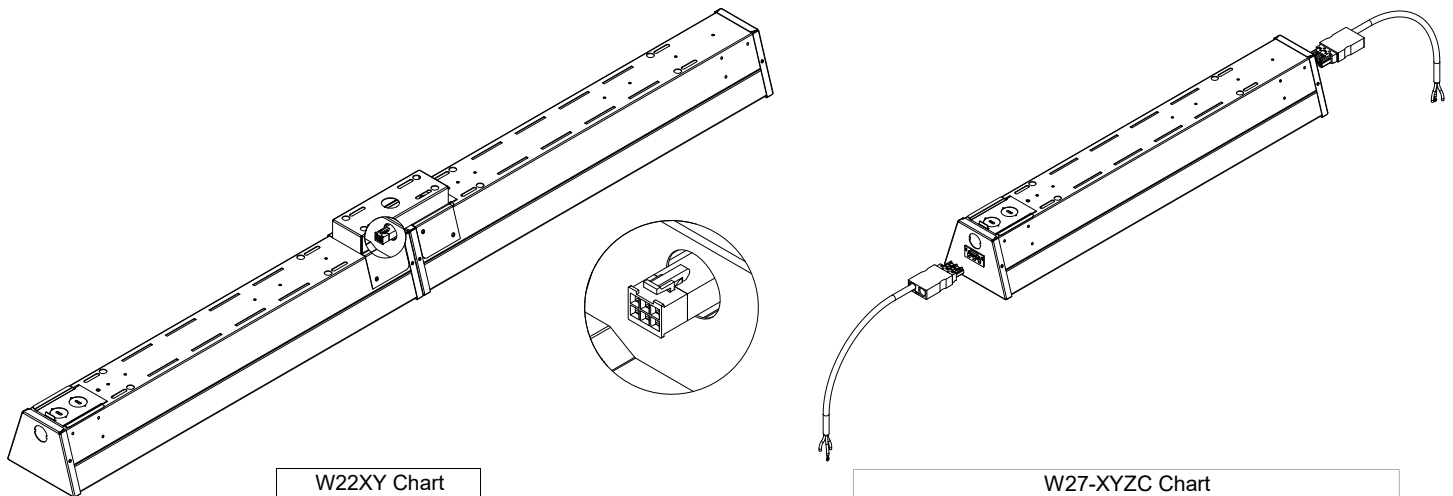

W22XY Chart	
X - Style	Y - Poles
E - End	3 - 3 Pole
	4 - 4 Pole
	5 - 5 Pole
	6 - 6 Pole

W27-XYZC Chart			
X - Style	X - Poles	Z - Wiring	C - Colour
S - Side	3 - 3 Pole	Blank - Standard	Blank - White
E - End	4 - 4 Pole	E - End of Row	B - Black
T - Top	5 - 5 Pole		G - Grey
	6 - 6 Pole		

MOUNTING

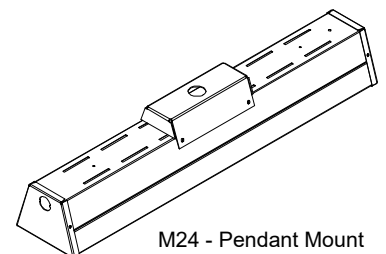
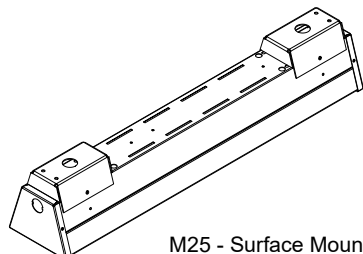
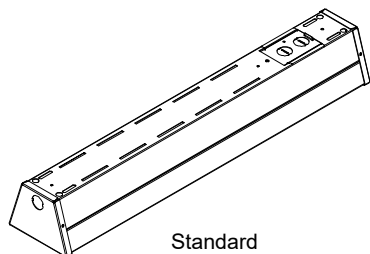

PHOTOMETRICS

BLLBT-4'-7.5L-840-L67

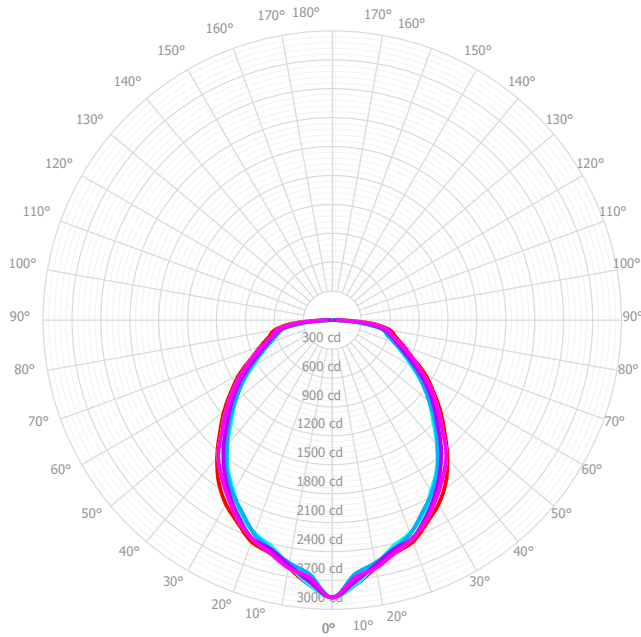

0°-180°	—
22.5°-202.5°	—
45°-225°	—
67.5°-247.5°	—
90°-270°	—
112.5°-292.5°	—
135°-315°	—
157.5°-337.5°	—

Mtg Height	Light Level	Beam Diameter
6.0 ft	79.9 fc	14.6 ft
8.0 ft	44.9 fc	19.5 ft
10.0 ft	28.8 fc	24.4 ft
12.0 ft	20.0 fc	29.3 ft
14.0 ft	14.7 fc	34.1 ft
16.0 ft	11.2 fc	39.0 ft

BLLBT-8'-15L-840-L67

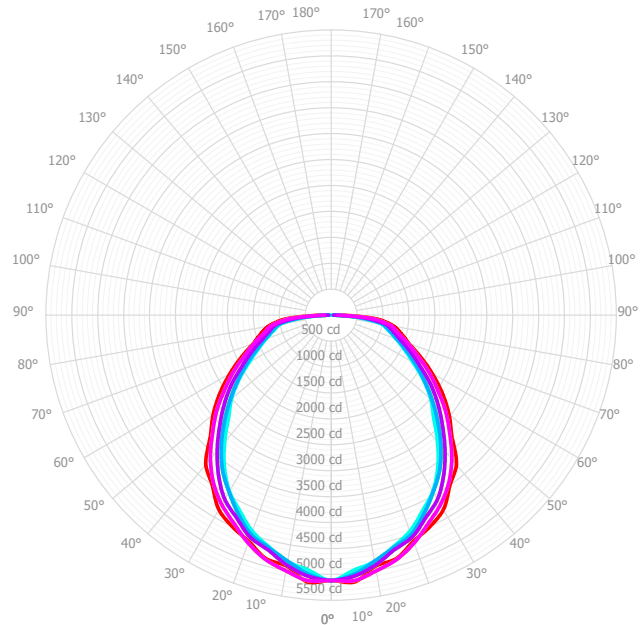

0°-180°	—
22.5°-202.5°	—
45°-225°	—
67.5°-247.5°	—
90°-270°	—
112.5°-292.5°	—
135°-315°	—
157.5°-337.5°	—

Mtg Height	Light Level	Beam Diameter
6.0 ft	142.1 fc	17.4 ft
8.0 ft	79.9 fc	23.2 ft
10.0 ft	51.2 fc	29.0 ft
12.0 ft	35.5 fc	34.8 ft
14.0 ft	26.1 fc	40.6 ft
16.0 ft	20.0 fc	46.4 ft

SPECIFICATIONS

BLLBT Efficiency Wattage Chart																						
Size	Lumen Output	Actual Lumen Output	Fixture Wattage	Lumens per Watt	Size	Lumen Output	Actual Lumen Output	Fixture Wattage	Lumens per Watt	Size	Lumen Output	Actual Lumen Output	Fixture Wattage	Lumens per Watt	Size	Lumen Output	Actual Lumen Output	Fixture Wattage	Lumens per Watt			
2'	1.75	1743	12.7	137.6	4'	4.5	4482	32.6	137.6	6'	6.75	6691	48.6	137.6	8'	9	8900	64.7	137.7			
	2.25	2241	16.29	137.6		5.5	5462	40.1	136.1		8.25	8073	59.8	134.9		11	10684	79.6	134.3			
	2.75	2731	20.06	136.1		6.5	6418	47.7	134.7		9.75	9488.5	71.1	133.5		13	12559	94.6	132.8			
3'	3.0	2973.8	21.6	137.6	4'	7.5	7355	55.2	133.3	6'	11.25	10872	82.3	132.0	8'	15	14389	109.5	131.4			
	3.5	3424.9	25.4	134.9		8.5	8268	62.7	131.9		12.75	12223	93.6	130.6		17	16177	124.4	130.0			
	4.0	3892.7	29.2	133.5		9.5	9162	70.3	130.4		14.25	13543	104.8	129.2		19	17924	139.4	128.6			
	4.5	4348.8	32.9	132.0		10.5	10034	77.8	129.0		15.75	14831	116.1	127.8		21	19627	154.3	127.2			
	5.0	4793.1	36.7	130.6		11.5	10889	85.4	127.6		17.25	16095	127.4	126.4		23	21301	169.4	125.8			
	5.5	5227.1	40.5	129.2		Based on UNV Voltage																
	6.0	5649.7	44.2	127.8		Based on 4000K																
	6.5	6064.8	48.0	126.4		Based on 80 CRI																